



# Nobleman Stall Series



**System Equine**

14321 Fifth Line Nassagaweya • Rockwood, ON • N0B 2K0

1 (800) 461-3362 • [Sales@SystemEquine.com](mailto:Sales@SystemEquine.com)

[SystemEquine.com](http://SystemEquine.com)

## Introduction

---

Our Nobleman Stall Series stands tall and proud. The strong Nobleman design is perfect for a hobbyist or a professional working, training, and boarding stable. The Nobleman is in our Designer Slide Collection, but can be hinged if desired. To add even more elegance to the Nobleman, a variety of caps and finials are available as well as arches to grace the top of the doors. This stall is available in a hot-dipped galvanized or a powder-coated finish. Choose from a large variety of options to suit your facility or give us a call if you had something else in mind.

- Our most elegant and sophisticated design thanks to its added height and functional features
- 8' high for a grand look
- Distinct V on door can be opened, closed, or taken off
- Brass, stainless, or painted accents available
- Many upgrading options available
- Fully adjustable stainless steel hinges with rounded tabs to minimize injuries
- Available in both powder-coated colour or hot-dipped galvanized finishes

## Why Choose System Stalls?

---

With so many options when choosing stalls for horses, things can sometimes be confusing; at System Equine we make it easier. Whether you own a two-stall private barn or a 60-stall boarding facility, you can be assured we have a stall system to meet your needs.

Our stalls are constructed with a high level of attention to detail, excellence of craftsmanship, along with the safety of horse and owner in mind. In our welded systems (every stall series except Standard), each bar is placed through pre-punched holes in the u-channel then welded securely in place for the most durability and best look. Alternatively, sonic welds or spot welding will show depletions over time. Our enclosed round track hardware for sliding doors and heavy-duty two-way adjustable hinges with Delran bushings will keep your stall functioning and feeling smooth for years to come.

Whichever stall system you choose, you can be sure that System Equine will be with you every step of the way. Our trained staff is here to answer your questions and provide decades of experience with finding the right horse stall, stall supplies, and other equine products for your facility. Our team includes some of the most skilled horse stall designers and builders in the world, that's the System advantage.

## Latch & Feed Options

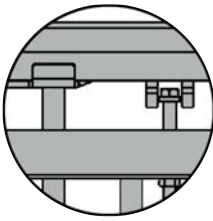

**Springloaded Bar Latch**



**Pin Latch**

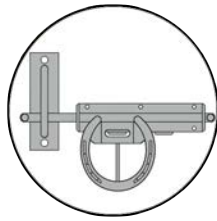

**Lockable Horseshoe Latch**



**Feed Opening**

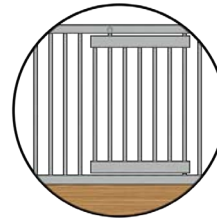

**Swing-out Feed Door**



**Swivel Feed Door**

## Door Options

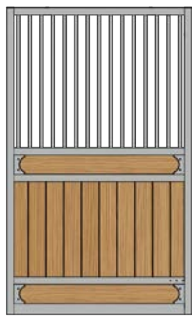

**Grill Top**

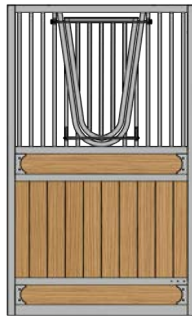

**Nobleman V**

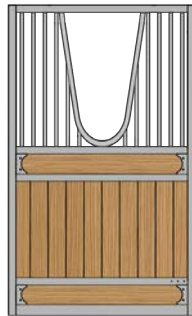

**Nobleman V Opening**

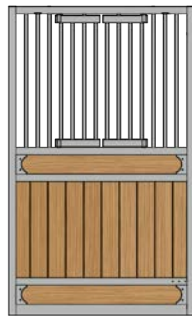

**Shutter**

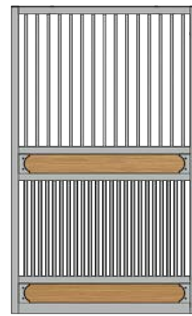

**Full Grill**

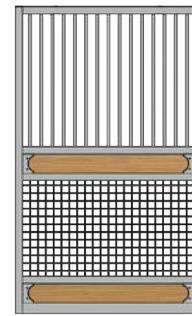

**Mesh Bottom**

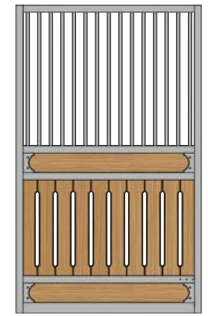

**Vented Wood**

Different tops and bottoms can be combined to create your perfect door!  
E.g. Full Grill Nobleman V (left) or Mesh Bottom Shutter (right)

## Flange Options

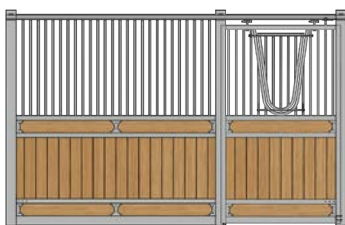

**Top & Bottom Flanges**



**Top Flanges**

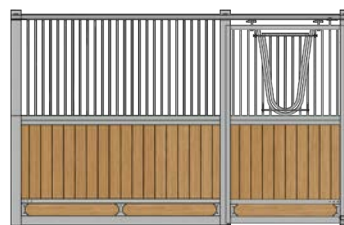

**Bottom Flanges**



**No Flanges**

## Other Options

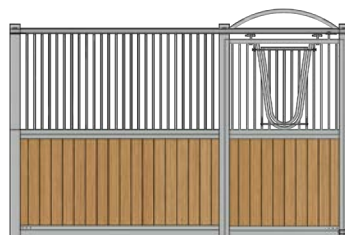

**Door Arch**

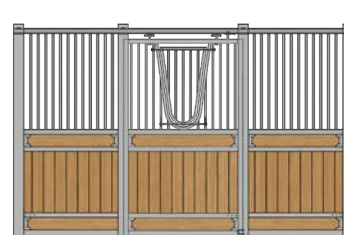

**Center Door**

## Pictures

---

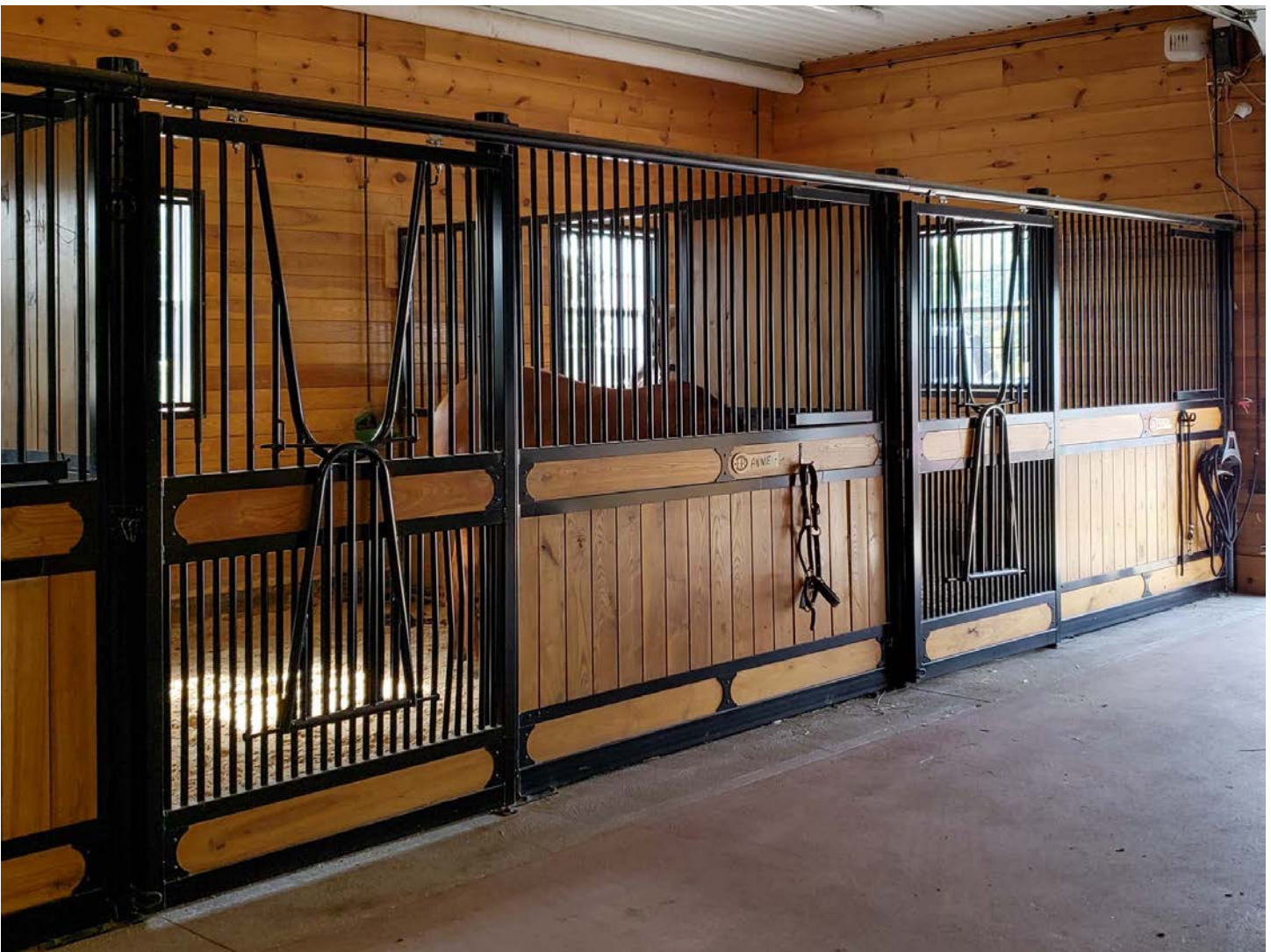

## Pictures

