

FINISH LINE STALL SERIES

None

Feed Opening

Feed Door

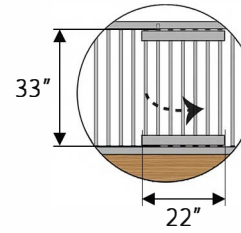
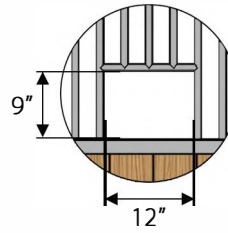

No Door

½ Swing Door

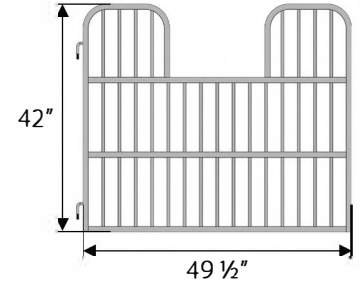

Full Swing Door

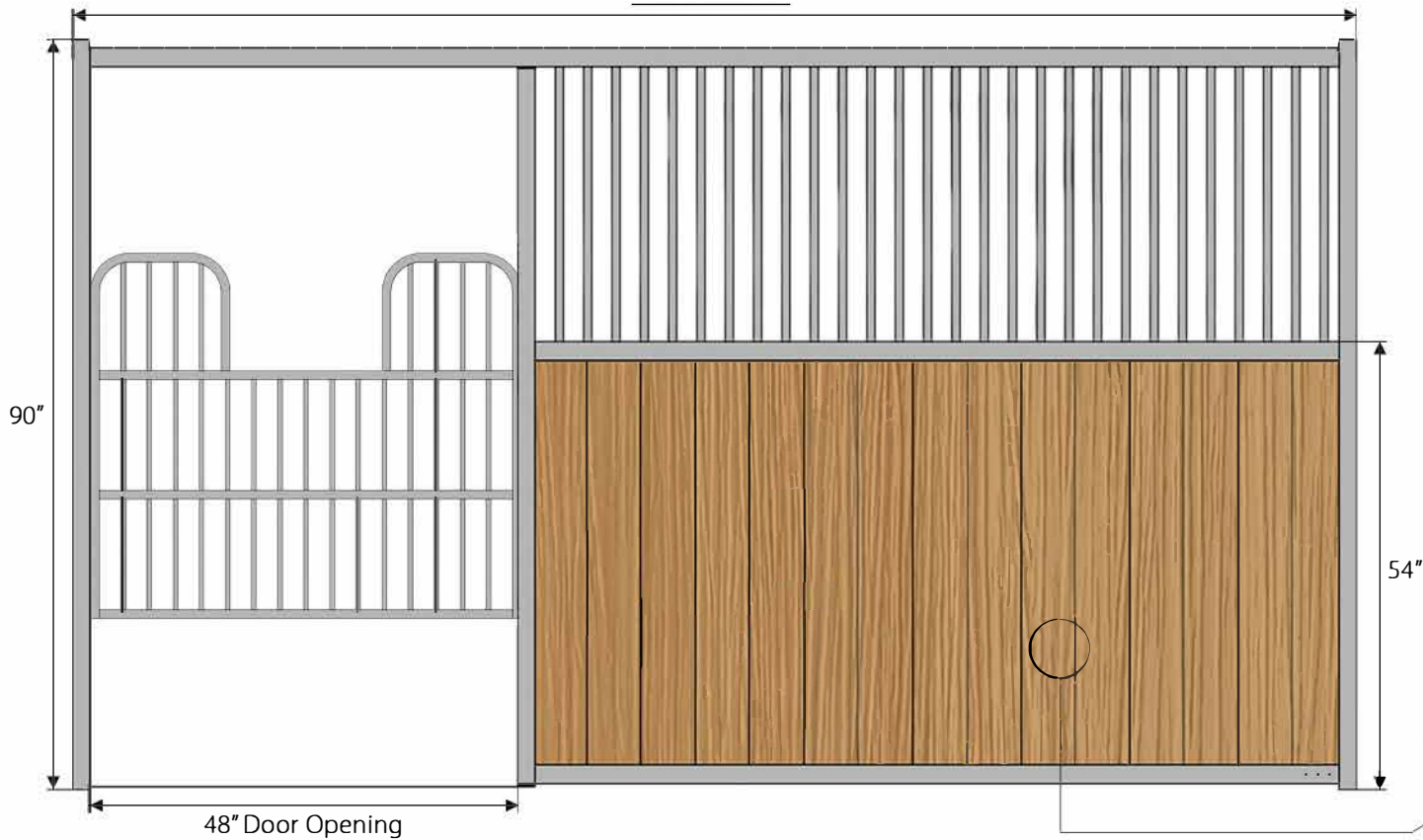
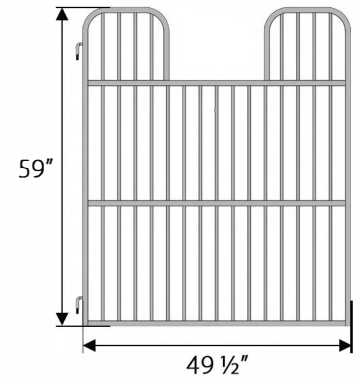

Optional Vented Wood

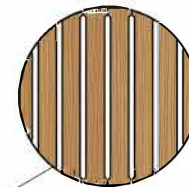

Wood requirements:

12 tongue & groove ash boards at 10' or 12' lengths

Left qty: ____ (pictured)	Finish:	Galvanized	Custom Powder Coated Paint:	Feed option:	Feed Door	None	Door:	½ Swing (included)	None
Right qty: ____		Black Powder Coated Paint	_____		Feed Opening	Full Swing			
Partition post:	Wood Steel	Connector	Aisleway flooring thickness:	Flush ¾"	Other: _____"	Notes:			



PROPRIETARY AND CONFIDENTIAL
 THIS DIAGRAM IS SENT AS A COURTESY TO OUR CLIENTS AND IS A COPYRIGHTED AND PROPRIETARY DESIGN OWNED BY SYSTEM FENCING LIMITED. PHOTOCOPYING OR REPRODUCTION OF ANY KIND WITHOUT THE WRITTEN CONSENT OF SYSTEM FENCING LIMITED IS PROHIBITED.
 BY SIGNING, THE BUYER, REPRESENTATIVE OF THE BUYER, OR CONTRACTOR TAKES FULL RESPONSIBILITY FOR THE DIMENSIONS ON THIS FORM. ANY CHANGES PRIOR TO FABRICATION MUST BE MADE IN WRITING. ANY CHANGES MADE AFTER FABRICATION HAS BEGUN WILL BE BILLED BACK AT THE LIST PRICE OF ANY ITEMS THAT WERE FABRICATED AT THE TIME OF THE CHANGE

FINISH LINE STALL SERIES

CUSTOMER: _____

SALES: _____

CUSTOMER SIGNATURE:

X _____ DATE: _____

SYSTEMEQUINE.COM • 1 (800) 461-3362

REVISED 01/24

FREE-STANDING STALL COLLECTION PARTITIONS

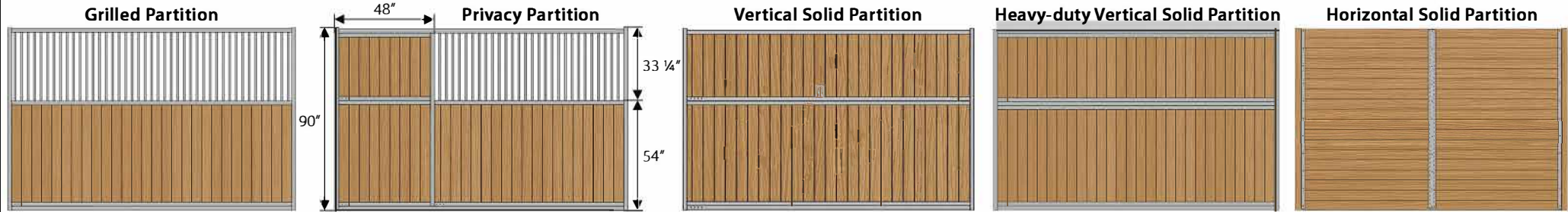

Includes: 90" high stall panel with a 33 1/4" high grilled social area on top. Standard lengths of 120" and 144" or custom sizes available.

Wood requirements (not included): 120" partition 24x @ 50 1/2" cut length (12x 10' 2x6 boards), 144" partition 28x @ 50 1/2" cut length (14x 10' 2x6 boards)

Includes: 90" high stall panel with a 33 1/4" high grilled social area on top with a solid 45" private area. Standard lengths of 120" and 144" or custom sizes available.

Wood requirements (not included): 120" partition 24x @ 50 1/2" cut length and 10x @ 32" cut length (12x 10' and 3x 12' 2x6 boards), 144" partition 28x @ 50 1/2" cut length and 10x @ 32" cut length (14x 10' and 3x 12' 2x6 boards)

Includes: 90" high stall panel solid to the top. Great for use in stallion areas or boarding barns. Standard lengths of 120" and 144" or custom sizes available.

Wood requirements (not included): 120" partition 24x @ 50 1/2" cut length, 24x @ 32" cut length (12x 10' and 6x 12' 2x6 boards), 144" partition 28x @ 50 1/2" and 10x @ 32" cut length (14x 10' and 8x 12' 2x6 boards)

Includes: 90" high stall panel solid to the top. Great for use in stallion areas or boarding barns. Standard lengths of 120" and 144" or custom sizes available.

Wood requirements (not included): 120" partition 24x @ 48 1/2" cut length, 24x @ 32" cut length (12x 10' and 6x 12' 2x6 boards), 144" partition 28x @ 48 1/2" and 10x @ 32" cut length (14x 10' and 8x 12' 2x6 boards)

Includes: 90" high stall panel solid to the top. Great for use in stallion areas or boarding barns. Horizontal wood cuts the cost down and makes it easy to customize length. Length of partition is determined by length of boards used.

Wood requirements (not included): 18x 2x6 boards (length is determined by the distance from the back wall to the stall front)

Grilled Partition	Regular	Finish:	Galvanized	Custom Powder Coated Paint:	Qty: _____
	Heavy-duty		Black Powder Coated Paint		_____
Privacy Partition	Regular	Finish:	Galvanized	Custom Powder Coated Paint:	Qty: _____
	Heavy-duty		Black Powder Coated Paint		_____
Vertical Solid Partition	Regular	Finish:	Galvanized	Custom Powder Coated Paint:	Qty: _____
	Heavy-duty		Black Powder Coated Paint		_____
Horizontal Solid Partition	Finish:	Galvanized	Custom Powder Coated Paint:	Qty: _____	
		Black Powder Coated Paint	_____	_____	

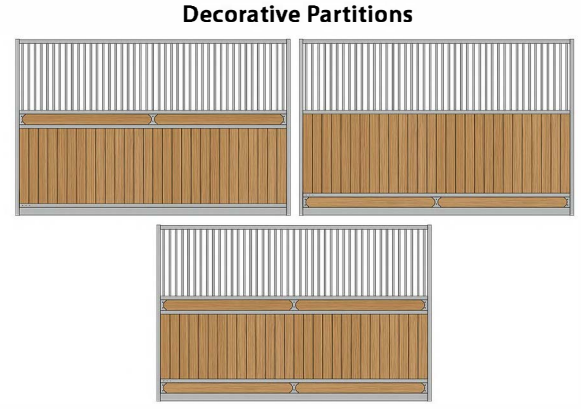

Decorative Partition	Grilled qty: _____	Privacy qty: _____	Solid qty: _____	Regular	Finish:	Galvanized	Custom Powder Coated Paint:
	Grilled length: _____	Privacy length: _____	Solid length: _____				

Notes: _____

Flanges: Top _____ Bottom _____ Top & Bottom _____



PROPRIETARY AND CONFIDENTIAL
 THIS DIAGRAM IS SENT AS A COURTESY TO OUR CLIENTS AND IS A COPYRIGHTED AND PROPRIETARY DESIGN OWNED BY SYSTEM FENCING LIMITED. PHOTOCOPIING OR REPRODUCTION OF ANY KIND WITHOUT THE WRITTEN CONSENT OF SYSTEM FENCING LIMITED IS PROHIBITED.
 BY SIGNING, THE BUYER, REPRESENTATIVE OF THE BUYER, OR CONTRACTOR TAKES FULL RESPONSIBILITY FOR THE DIMENSIONS ON THIS FORM. ANY CHANGES PRIOR TO FABRICATION MUST BE MADE IN WRITING. ANY CHANGES MADE AFTER FABRICATION HAS BEGUN WILL BE BILLED BACK AT THE LIST PRICE OF ANY ITEMS THAT WERE FABRICATED AT THE TIME OF THE CHANGE.

FREE-STANDING STALL COLLECTION PARTITIONS CUSTOMER: _____

SALES: _____

CUSTOMER SIGNATURE: _____

x _____ DATE: _____

SYSTEMEQUINE.COM • 1 (800) 461-3362 REVISED 01/24